

## Type MA 221

2-way solenoid valve  
direct actuated, NC  
(normally closed)

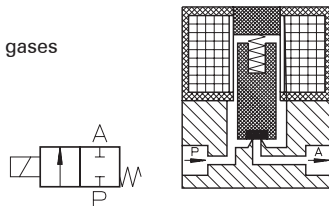

**Application**  
Neutral liquids, gases  
and vapors



Type/ Order No.	Orifice [mm]	Port size	Pressure range [bar]		kv-value [m³/h]	Weight [kg]
			AC	DC		
MA 221-004	1,0	G 1/8	0 - 20	0 - 12	0,03	0,100
MA 221-005	1,6	G 1/8	0 - 16	0 - 10	0,06	0,100
MA 221-006	2,2	G 1/8	0 - 10	0 - 6	0,11	0,100
MA 221-007	2,2	G 1/8	0 - 10	0 - 6	0,11	0,100

Sealing material: **P** (NBR) **E** (EPDM) **V** (FPM)

Body material: Brass  
 Inner parts: Stainless steel (1.4105)  
 Mounting direction: Free, preferred upwards  
 Max. ambient temp.: 50 °C  
 Viscosity of the medium: max. 21 mm²/s (3 °E)  
 Static pressure: max. 30 bar  
 Standard voltage: DC: 24, 12 V  
 AC: 230 V, 115 V, 42 V,  
 24 V, 12 V, (50 or 60 Hz)

Power consumption: 5 VA / 5 W  
 Voltage tolerance: -15%... +10%  
 Duty cycle: 100%  
 Operating frequency: max. 1000/min  
 Degree of Protection: IP 54 (EN 60529)

Other configurations upon request

114

staiger

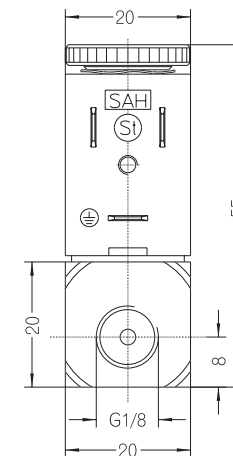
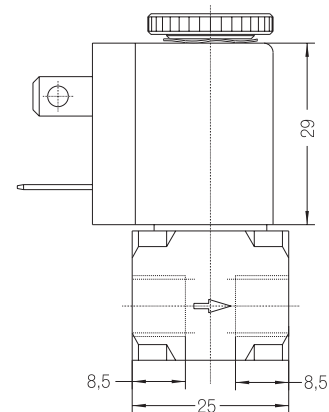
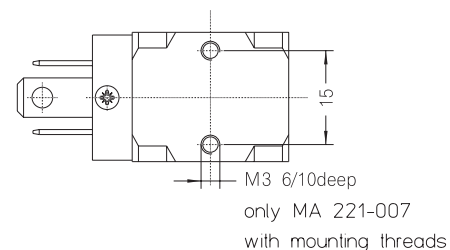

The right to modification is reserved

115

Dimensions in mm